



TETON

Natural Reliability™



XA SERIES

XA20K

Teton Aeration Kit
ASSEMBLY INSTRUCTIONS

Teton Dynamics
P.O. Box 3031
San Leandro, CA 94578-0031

Teton Dynamics
P.O. Box 3031
San Leandro, CA 94578-0031

TETON AERATION KIT XA20K

VERSION AUG 2020

www.tetonus.com

800.752.0399

info@tetonus.com

**WELCOME TO THE WORLD OF TETON,
NATURAL RELIABILITY!**

You Made The Right Choice Investing In These Quality Products. Thank You And Enjoy.

BEFORE USING THESE PRODUCTS, PLEASE READ THESE INSTRUCTIONS CAREFULLY AND FAMILIARIZE YOURSELF WITH THE ITEMS. PLEASE KEEP ASSEMBLY MANUAL IN A SAFE PLACE FOR FUTURE REFERENCE.

INTRODUCTION

The preceding configuration shows the simple assembly for assembling your new Teton Aeration Kit.

CONTENTS OF KIT

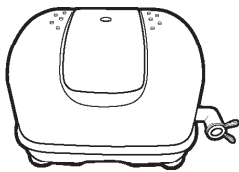

XAP20 Air Pump

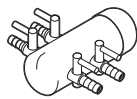

XAM4 Air Valve

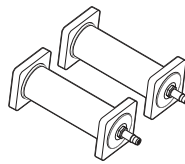

XAS5 Air Stones x 2
(1.25" x 5")



15316C Air Tubing x 2
(3/16" x 15ft)

STEP 1

- With the air stones in hand, slip the tubing onto the barbed fittings, applying a little pressure.

FIGURE A

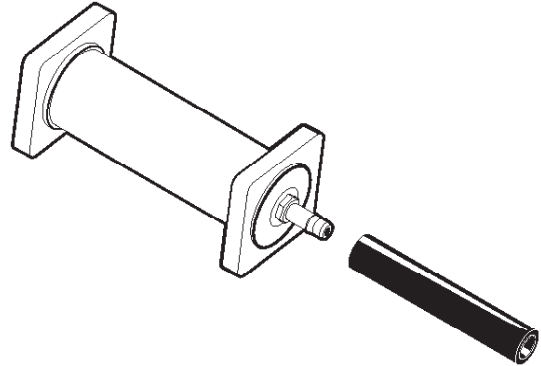

STEP 2

- Locate 4-way manifold (provided with kit). While applying pressure, connect both hose ends onto the two barbed fittings. Open the valves on the two connections you have connected to and close the valves on the remaining two outlets.

FIGURE B

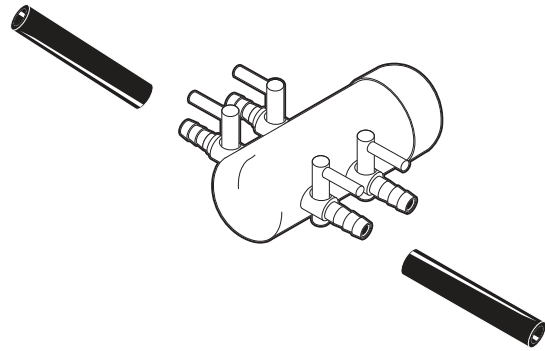

STEP 3

- Remove pump from the box and locate the parts bag (provided in the pump box). Connect the ring style clamps by squeezing them onto both ends of the rubber coupling elbow. Then connect it to the pump on the port marked "OUT." Attach the other end of rubber coupling onto the large end of the 4-way manifold tee.

FIGURE C

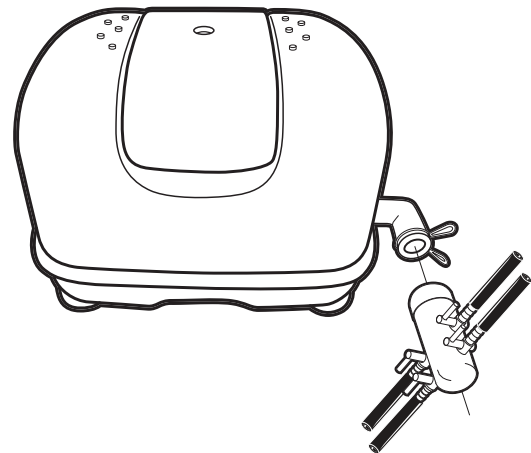

STEP 4

- Locate air pump in an area free of dust and avoid areas prone to flooding. Air pumps located in areas below water level will require a check valve to prevent potential water flow back into the pump. Then place the airstones in the desired area of the pond and plug in the power cord to a GFCI protected power supply.

FIGURE D

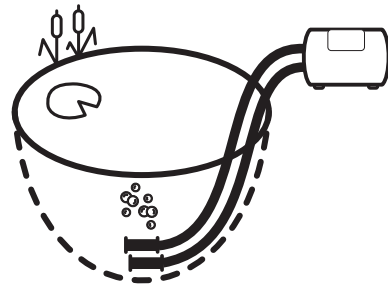

SYMBOLS AND MEANING

DANGER

- DANGER: Keep the pump out of the reach of children!
- Warns that the failure to follow the directions given could cause serious risk to individuals or objects.



WARNING

- WARNING: This sign warns the operator that the failure to follow instructions, may damage the pump or the system.



Please consult your retailer for quality original Teton replacement parts.
Visit www.tetonus.com for your nearest dealer.

TETON
Natural Reliability™
800.752.0399
info@tetonus.com